

Description of sensor

Kic2 is our temperature monitoring sensor that fits in the palm of your hand.

Combined with the FoodDeck app, Kic2 is the optimal compliance tool to facilitate audits in the food service and food retail industries. With its hanging slots and magnets for countless hanging options, Kic2 is ideal for fridges, cold rooms, food warmers, racks, and other small areas.

Features

- Measures the temperature of its surrounding environment
- Uses LoRaWAN technology for increased range through heavy walls
- Hanging slots and built-in magnets cater for various mounting options
- Case is made out of Food-safe material and is water resistant
- Easy installation

Applications



Temperature
monitoring
(cold)



Temperature
monitoring
(hot)

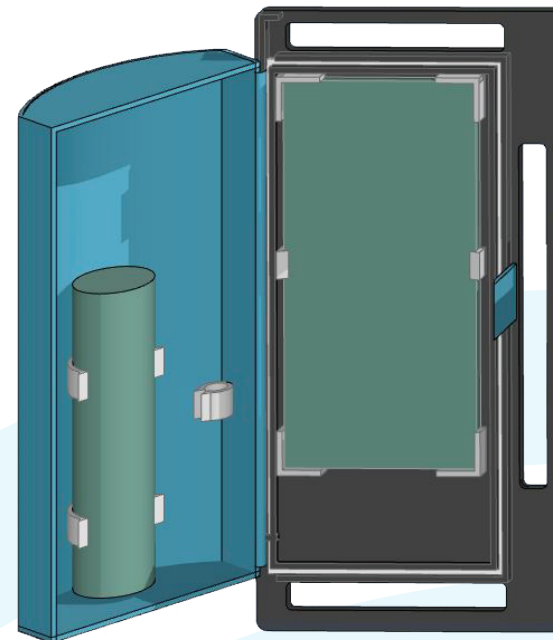

- Hinged lid with seal-tight edges
- Built in antenna
- AA battery
- Battery wire support ring
- Built-in mounting magnets
- Hanging slots for a range of mounting options

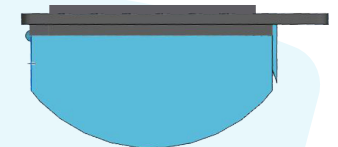

Mechanical Features

Housing	Hinged lid with rubber seal-tight edges Built-in magnets
Dimensions (mm)	112 x 60 x 25 mm
Weight	approx. 45 grams, 65 grams (with battery)
Case material	SLA resin with food-safe polyurathane coating

Device Power Supply

Battery	3.6V Primary Lithium Thionyl Chloride (Li-SOCI ₂) Operating temperature range -55°C to +85 °C
Expected battery life	Up to 7 years, depending on configuration and environment

Operationing Conditions

Temperature	-40°C to +125 °C
-------------	------------------

Radio/Wireless Connection

Wireless technology	LoRaWAN 1.0.3/1.1
Supported LoRaWAN device type	Class A End-device
Supported LoRaWAN Regions	US902 - 928, AS923, AU915 - 928, KR920-923
Configuration	OTAA, ABP, ADR

Data Type

Temperature	-40°C to +85 °C
-------------	-----------------

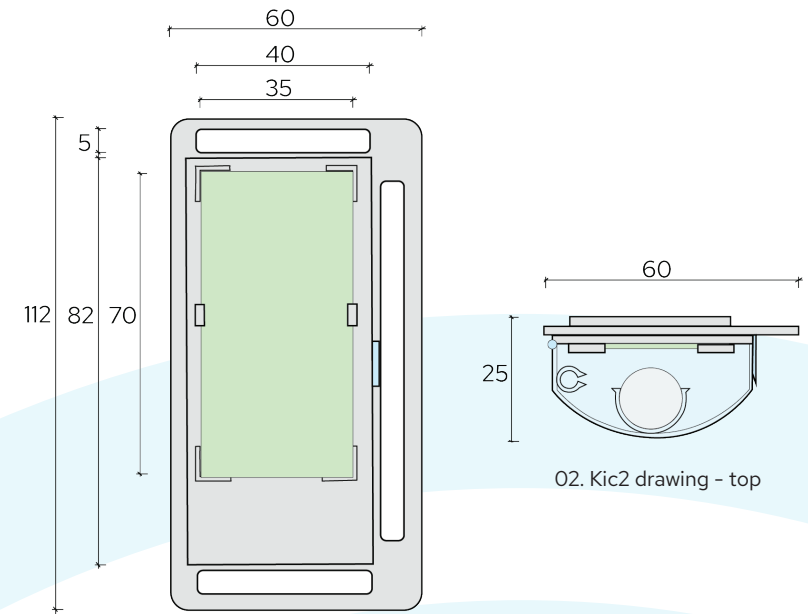

01. Kic2 drawing - front

02. Kic2 drawing - top